



## REEM VI

JUMEIRAH 3, DUBAI



صديقي للعقارات  
SEDDIQI PROPERTIES



## A TRANQUIL PARADISE

Nestled in the heart of Umm Suqeim, REEM VI is a stunning compound encompassing a modern and clean design. The property is located close to Jumeirah Beach Road and provides easy access to landmarks such as Al Wasl Road, Wild Wadi Park and Novomed Medical Clinic.

The compound includes three unique properties, each featuring 4 bedrooms, a maid's room, private swimming pool and are fitted with the latest kitchen appliances. The community provides for a perfect environment for a family in the heart of the city.

Contemporary design meets spectacular views across these large villas, which are 5859 sq. ft each. The property is equipped with a well-manicured garden and includes landscaping and gardening fees in the rent.

With natural light and a modern palette at the heart of this property, it is a great choice for those in pursuit of a tranquil paradise.

## OVERVIEW OF PROPERTY AMENITIES & LANDMARK INFO

### Property Amenities

- Private outdoor temperature control swimming pool
- Private garden
- Fully fitted kitchen
- Garage parking spaces for 2 cars per villa
- 24/7 maintenance helpdesk support
- Pet friendly property\*

\*T&Cs apply

### Included in the rent

- Maintenance
- Pool cleaning and maintenance
- Landscaping for private garden
- Managed by Seddiqi Properties

### Proximity to Landmarks

- Easy access to Malls, Schools, Hospitals, Mosques, Five Star Hotels, Parks, Restaurants and Beaches
- Conveniently located within proximity to Al Wasl Road, Royal Consulate of Denmark, Novomed Medical Clinic, Football Stadium, Wild Wadi Park, and Um Suquem Park



# FLOOR PLANS

---

## TYPE 4A

4 bedrooms + maid's room corner duplex villa in Reem VI with a view of Burj Al Arab

### Floor Plan Type 4A

- 4 bedrooms + maid's room
- Size: 5859
- Villas: 01

### Overview of unit

- 4 bedrooms
- 6 bathrooms

### Ground Floor

- Large living and dining area
- Closed kitchen
- Large en suite maid's room with built-in wardrobe
- Shower area
- Large private garden
- Large laundry room
- Storage room
- Outdoor temperature controlled swimming pool
- Garage parking for 2 cars

### 1st Floor

- Large en suite master bedroom with walk-in closet
- En suite 2nd, 3rd & 4th bedroom with built-in wardrobe
- Large family area
- Large terrace with access from family area
- Balconies from master bedroom and 2nd bedroom

### Appliances

- Stove
- Oven
- Fridge
- Dishwasher
- Washing machine
- Dryer

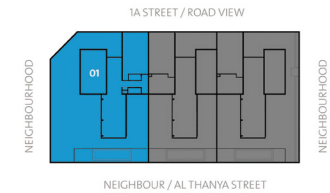

## TYPE 4B

4 bedrooms + maid's room corner duplex villa in Reem VI with a view of the community

### Floor Plan Type 4B

- 4 bedrooms + maid's room
- Size: 5859
- Villas: 02

### Overview of unit

- 4 bedrooms
- 6 bathrooms

#### Ground Floor

- Large living and dining area
- Closed kitchen
- Large en suite maid's room with built-in wardrobe
- Shower area
- Private garden
- Large laundry room
- Storage room
- Outdoor temperature controlled swimming pool
- Garage parking for 2 cars

#### 1st Floor

- Large en suite master bedroom with walk-in closet
- En suite 2nd, 3rd & 4th bedroom with built-in wardrobe
- Large family area
- Large terrace with access from family area
- Balconies from master bedroom and 2nd bedroom

### Appliances

- Stove
- Oven
- Fridge
- Dishwasher
- Washing Machine
- Dryer

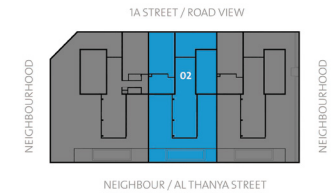

## TYPE 4C

4 bedrooms + maid's room corner duplex villa in Reem VI with a view of the community

### Floor Plan Type 4C

- 4 bedrooms + maid's room
- Size: 5859
- Villas: 03

### Overview of unit

- 4 bedrooms
- 6 bathrooms

#### Ground Floor

- Large living and dining area
- Closed kitchen
- Large en suite maid's room with built-in wardrobe
- Shower area
- Private garden
- Large laundry room
- Storage room
- Outdoor temperature controlled swimming pool
- Garage parking for 2 cars

#### 1st Floor

- Large en suite master bedroom with walk-in closet
- En suite 2nd, 3rd & 4th bedroom with built-in wardrobe
- Large family area
- Large terrace with access from family area
- Balconies from master bedroom and 2nd bedroom

### Appliances

- Stove
- Oven
- Fridge
- Dishwasher
- Washing Machine
- Dryer

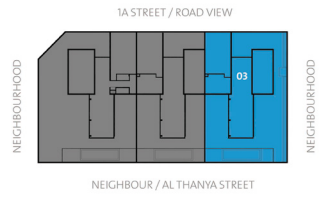



## DOCUMENTS & PAYMENT INFORMATION

---

### Leasing Documents and Payment Details:

- Payable up to 12 Cheques
- Booking Form
- Passport, Visa & EID of all occupants
- Salary Certificate
- Marriage Certificate (for couples)

### Fee:

- Rental amount (divided equally into number of cheques)
- Security Deposit - 5% of annual rent or minimum AED 5,000
- Ejari Fee – AED 210



**Contact Information:**

 800 SPROP (77767)

 [info@seddiqproperties.com](mailto:info@seddiqproperties.com)

 [seddiqproperties.com](http://seddiqproperties.com)

 [@seddiqproperties](https://www.instagram.com/seddiqproperties)

 [facebook.com/seddiqproperties](https://www.facebook.com/seddiqproperties)