



AL NADA 1 & 2

MANKHOOL, DUBAI



صديقي للعقارات
SEDDIQI PROPERTIES

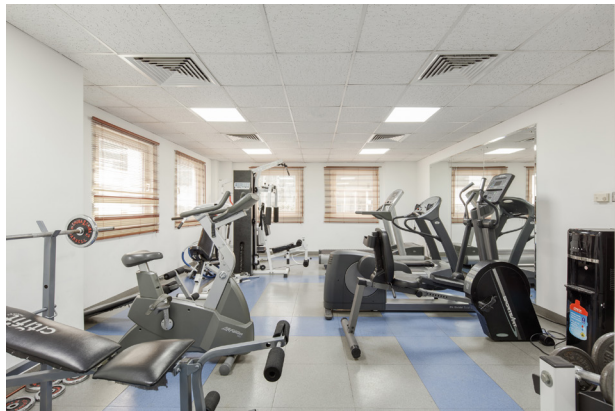

YOUR BEST LIFE

Al Nada is conveniently located in the centre of the Mankhool district amidst various well-connected transportation links, restaurants and shops.

The building is the residence of choice for those looking for well maintained and secure apartments, serviced by 24/7 security and a maintenance helpdesk support. The 44 residences offer a choice of quaint one, two- and three-bedroom apartments with built in wardrobe.

In addition, covered parking is available for residents, as well as an onsite gym.

Only a ten-minute walk from the ADCB Metro Station, Nada 1 and Nada 2 are the perfect choice for those seeking a base in the city without compromising on convenience.

OVERVIEW OF PROPERTY AMENITIES & LANDMARK INFO

Building Amenities

- Shared temperature controlled swimming pool
- Shared gym
- Central air conditioning
- Covered parking
- 24/7 on-site security
- 24/7 maintenance helpdesk support
- Pet friendly property*

*T&Cs apply

Included in the rent

- Chiller
- Maintenance
- Managed by Seddiqi Properties

Proximity to Landmarks

- Easy access to Malls, Hospitals, Mosque, Hotels, and Restaurants
- Conveniently located and within close proximity to Burjuman Center, Spinneys, Metro Station, Park Regis Hotel and Al Ibrahim Palace



FLOOR PLANS

1ST TO 2ND FLOOR

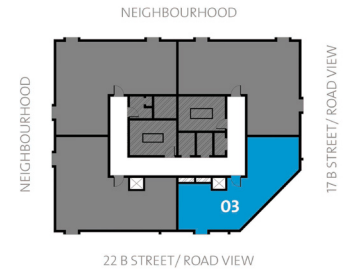

ONE BEDROOM (TYPE 1A) - AL NADA 1

1 bedroom apartment in Al Nada 1 with a community view of the Mankhool area in Dubai

Floor Plan Type 1A

- 1 bedroom
- Size: 785 sqft
- Floor: 1 & 2
- Series: 03

Overview of unit

- 1 bedroom
- 1.5 bathrooms
- En suite bedroom with built-in wardrobe
- Living & dining area
- Large closed kitchen

Built in appliances

- Cooker
- Cooker hood



1ST TO 7TH FLOOR - 01 SERIES
1ST TO 2ND FLOOR - 04 SERIES

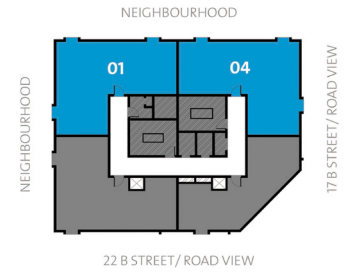

TWO BEDROOM (TYPE 2A) - AL NADA 1

2 bedrooms corner apartment in Al Nada 1 with a community view of the Mankhool area in Dubai

Floor Plan Type 2A

- 2 bedrooms
- Size: 969 sqft
- Floor: 1 - 7
- Series: 01 & 04

Overview of unit

- 2 bedrooms
- 2 bathrooms
- Large en suite master bedroom with built-in wardrobe
- 2nd bedroom with built-in wardrobe
- Living & dining area
- Large closed kitchen

Built in appliances

- Cooker
- Cooker hood



1ST TO 7TH FLOOR

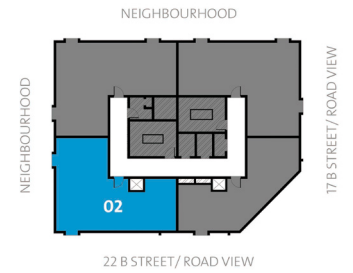

TWO BEDROOM (TYPE 2B) - AL NADA 1

2 bedrooms corner apartment in Al Nada 1 with a community view of the Mankhool area in Dubai

Floor Plan Type 2B

- 2 bedrooms
- Size: 969 sqft
- Floor: 1 - 7
- Series: 02

Overview of unit

- 2 bedrooms
- 2 bathrooms
- Large en suite master bedroom with built-in wardrobe
- 2nd bedroom with built-in wardrobe
- Living & dining area
- Large closed kitchen

Built in appliances

- Cooker
- Cooker hood



THREE BEDROOM (TYPE 3A) - AL NADA 1

3 bedrooms apartment in Al Nada 1 with a community view of the Mankhool area in Dubai

Floor Plan Type 3A

- 3 bedrooms
- Size: 1,528 sqft
- Floor: 3 - 7
- Series: 03

Overview of unit

- 3 bedrooms
- 2.5 bathrooms
- Large en suite master bedroom with built-in wardrobe
- 2nd & 3rd bedroom with built-in wardrobe
- Large living & dining area
- Large closed kitchen

Built in appliances

- Cooker
- Cooker hood



3RD TO 7TH FLOOR

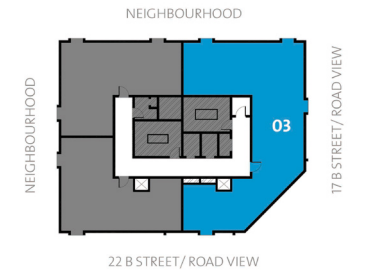

ONE BEDROOM (TYPE 1A) - AL NADA 2

1 bedroom apartment in Al Nada 2 with a community view of the Mankhool area in Dubai

Floor Plan Type 1A

- 1 bedroom
- Size: 861 sqft
- Floor: 7
- Series: 03

Overview of unit

- 1 bedroom
- 1.5 bathrooms
- En suite bedroom with built-in wardrobe
- Large living & dining area
- Closed kitchen

Built in appliances

- Cooker
- Cooker hood



7TH FLOOR

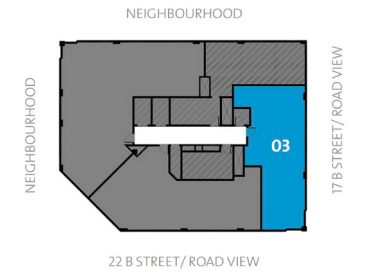

1ST TO 7TH FLOOR

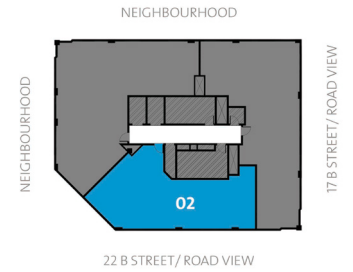

TWO BEDROOM (TYPE 2A) - AL NADA 2

2 bedroom apartment in Al Nada 2 with a community view of the Mankhool area in Dubai

Floor Plan Type 2A

- 2 bedrooms
- Size: 980 sqft
- Floor: 1 - 7
- Series: 02

Overview of unit

- 2 bedrooms
- 1.5 bathrooms
- Master & 2nd bedroom with built-in wardrobe
- Large living & dining area
- Large closed kitchen

Built in appliances

- Cooker
- Cooker hood



THREE BEDROOM (TYPE 3A) - AL NADA 2

3 bedrooms corner apartment in Al Nada 2 with a community view of the Mankhool area in Dubai

Floor Plan Type 3A

- 3 bedrooms
- Size: 1,281 sqft
- Floor: 1 - 6
- Series: 03

Overview of unit

- 3 bedrooms
- 2 bathrooms
- Large en suite master bedroom with built-in wardrobe
- 2nd & 3rd bedroom with built-in wardrobe
- Large living & dining area
- Closed kitchen

Built in appliances

- Cooker
- Cooker hood



1ST TO 6TH FLOOR

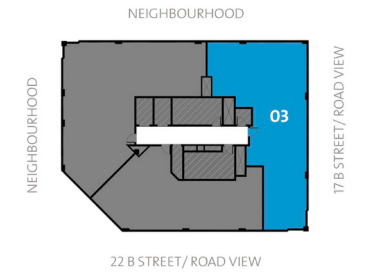

THREE BEDROOM (TYPE 3B) - AL NADA 2

3 bedrooms apartment in Al Nada 2 with a community view of the Mankhool area in Dubai

Floor Plan Type 3B

- 3 bedrooms
- Size: 1,281 sqft
- Floor: 1 - 7
- Series: 01

Overview of unit

- 3 bedrooms
- 2.5 bathrooms
- Large en suite master bedroom with built-in wardrobe
- 2nd & 3rd bedroom with built-in wardrobe
- Living & dining area
- Large closed kitchen

Built in appliances

- Cooker
- Cooker hood



1ST TO 7TH FLOOR

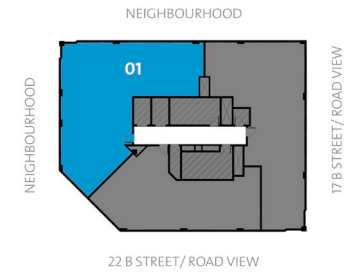



DOCUMENTS & PAYMENT INFORMATION

Leasing Documents and Payment Details:

- Payable up to 12 Cheques*
- Booking Form
- Passport, Visa & EID of all occupants
- Salary Certificate
- Marriage Certificate (for couples)

* T&Cs apply

Fee:

- Rental amount (divided equally into number of cheques)
- Security Deposit - 5% of annual rent or minimum AED 3,000
- Ejari Fee – AED 210

Contact Information:

 800 SPROP (77767)

 info@seddiqproperties.com

 seddiqproperties.com

 [@seddiqproperties](https://www.instagram.com/seddiqproperties)

 [facebook.com/seddiqproperties](https://www.facebook.com/seddiqproperties)